



## Products and Prices







*The 2015 Pan Am/Parapan Am Games Cauldron*



*Advanced high-strength steel for auto*



*Steel-intensive home by BONE Structure™*

## About ArcelorMittal

ArcelorMittal is the world's leading steel and mining company. Guided by a philosophy to produce safe, sustainable steel, it is the leading supplier of quality steel products in all major markets including automotive, construction, energy, household appliances and packaging. ArcelorMittal is present in more than 60 countries and has an industrial footprint in over 20 countries.

With a strong presence in North America, Europe, South America and South Africa, and an emerging presence in China, ArcelorMittal delivers a large scale of products, solutions and services to customers with the same quality focus in all regions. ArcelorMittal is the leader in steel technology, both in the breadth and depth of our product portfolio, and in our ability to supply a range of grades throughout the world.

ArcelorMittal is a supplier of choice for all markets, a testament of our commitment to working collaboratively with our customers to engineer advanced steel grades to meet their needs.

## About ArcelorMittal Dofasco

ArcelorMittal Dofasco is Canada's leading steel producer and a hallmark of advanced manufacturing in North America. Headquartered in Hamilton, Ontario, and founded in 1912, ArcelorMittal Dofasco is Canada's largest producer of flat carbon steel. Our 5,000 employees are dedicated to being world class as we strive to transform tomorrow with lighter, stronger and more sustainable steel.

ArcelorMittal Dofasco plays a key role in North America's advanced manufacturing supply chain working with the top automotive, energy, packaging and construction brands to develop lighter, stronger and more sustainable products – from cans to cars.

ArcelorMittal is ranked amongst the world leaders in steel for research and development (R&D), with 11 research centers throughout the world, including in Hamilton, ON at Dofasco. Globally, our 1,400 researchers are dedicated to pushing the limits of steel and materials science through product and process development.

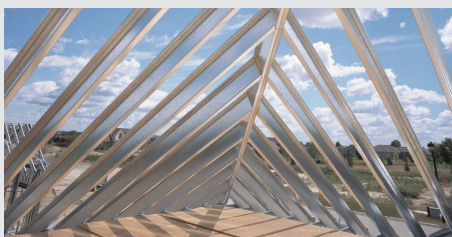

*Lightweight steel framing provides the foundation for stronger, safer and more sustainable buildings.*



*Steel used for tubular applications in the energy sector.*



*Galvanized steel has the strength and durability required for culverts.*



*Our galvanized steel is used extensively for commercial grain storage.*



*Our tin coated steel is used for canned food, an efficient, economical and nutritional way to package food.*

# Table of Contents



## Products and Prices

General Pricing Notes..... 3

Packaging..... 4

Hot Rolled Steel Sheet ..... 5

Cold Rolled Steel Sheet..... 7

Galvanized & Galvanneal Steel Sheet..... 10

Galvalume™ Steel Sheet..... 15

Tin Mill Products..... 19

Electrolytic Tin Coated & Chrome Coated Sheet..... 22

Tin Mill Products General Pricing Notes ..... 23

Pre-Coat Products..... 24

# General Pricing Notes



1. ArcelorMittal Dofasco Terms and Conditions of Sale (and the Dofasco Price Book) are available for review at <https://ec.dofasco.ca>
2. All prices are in Canadian Dollars per 100 pounds (Cdn \$/cwt) unless otherwise noted, FOB producing mill or processor, with no freight equalization. Prices are subject to change without notice.
3. All initial orders require metallurgical assessment to determine mill acceptance;
  - a) Not all thickness/width/grade combinations are available across our entire dimensional range.
  - b) Non-standard specifications or specifications with modified chemistries, mechanical properties or coatings must be reviewed and may result in specific order quantities and/or additional charges.
  - c) Certain grades will be subject to minimum heat lot order quantities.
  - d) An item is considered one size and grade, and coating (if applicable) for delivery to one destination at one time.
  - e) Grade extras include test reports where required by specification designation.
4. "Master Coil" PIW (pounds per inch of width) refers to the coil as produced through the Hot Mill operation. Ordered finished coil weights and PIW's must align with ordered quantities and mode of transportation. Customers are obligated to accept excess production from misaligned PIW and order quantity
  - a) Standard order quantity is  $\geq 2$  master coils. The coil calculation tool, which uses a combination of ID, OD and lift capability, is provided to help estimate master coil size. ArcelorMittal Dofasco reserves the right to waive permissible variation in order quantity for orders less than standard order quantity. For assistance, please consult with your Inside Sales Rep.
  - b) ArcelorMittal Dofasco strives for maximum coils weights. A minimum of 80% of ordered weight will be supplied as full weight coils. A full weight coil, with or without welds, is any coil weighing more than 75% of the specified or maximum coil weight on the basis of normal mill production practice. Lightweight coils accruing from production will be shipped up to 20% of the ordered item weight. A lightweight coil is any coil between 50% and 75% of the specified or required maximum coil weight.
  - c) Process variation makes it difficult to provide precise order quantities on small orders. We will call orders "complete" when balances owing are less than 10,000 lbs and less than 75% of max coil weight or when we have produced the following percentages of order weight;

Ordered weight (tons)	<60t	60-250t	>250-500t	>500-1000t	>1000t
% produced to call complete	90%	95%	96%	97%	98%

When an order is not complete, ArcelorMittal Dofasco will produce and the customer will be obligated to take, the additional full coil weight to reach the call complete order levels even though produced weight may then exceed ordered quantity.

5. Standard packaging for Hot Rolled, Cold Rolled, Galvanized, and Galvalume products is bare and for lifts greater or equal to 20,000 lbs. Custom packaging changes will be additional to PIW charges if applicable. For Pre-Coat Products, standard packaging is coil eye vertical on a skeleton platform, single paper wrapped. Please inquire for custom packaging price extras.

## General Pricing Notes



### Packaging Prices

\$/cwt

Packaging prices are driven by the materials used and the labour required to prepare lifts for shipment. Small lifts incur much greater costs per cwt for the same packaging configuration/code.

\$/cwt	Weight of Smallest Coil in Package		
	>= 20,000 lbs	>=10,000 to <20,000 lbs	<10,000 lbs
Base Charge (Bare with banding)	0.00	0.15	0.30
Additional Feature Charges			
Hand Wrapped (VW), Axial Machine Wrapped (AK), or any other Wrapping	0.20	0.40	0.60
Cocoon Machine Wrapped (VK)	0.30	0.60	0.90
Platforms/ Skids	0.20	0.40	0.60
Spacers	0.20	0.40	0.60
Sidewall Protection or Shrouding	0.05	0.10	0.20
ID Protection (eg. core liners)	0.05	0.10	0.20
Customized Packaging Charge *	Inquire	Inquire	Inquire

*\*Infrequently used or modifications to standard codes*

Please consult with your sales account personnel regarding customized packaging and coils less than 5000 lbs to minimize packaging charges.

Effective: January 1<sup>st</sup>, 2018

# Hot Rolled Steel Sheet

Dofasco schedule of price extras, Cdn \$/cwt



Thickness and Width (inches)					\$/cwt
MIN GAUGE	NOM GAUGE	30" to <36"	36" to <42"	42" to <48"	48" to 62"
≥0.491	≥.501	5.50	4.50	2.00	0.50
.090 - <.491	.097 - <.501	5.00	4.00	1.50	0.00
.083 - <.090	.090 - <.097	5.00	4.00	1.50	0.00
.071 - <.083	.078 - <.090	6.00	5.00	2.50	1.50
.061 - <.071	.067 - <.078	7.00	6.00	3.50	3.00
.054 - <.061	.060 - <.067	8.00	7.00	4.50	4.00

Unless otherwise specified, Hot Rolled products are produced to ASTM Specifications A1011 or A1018.

Not all thickness/width/grade combinations are available across our entire dimensional range.

Non-standard specifications or specifications with modified chemistries, mechanical properties or coatings must be inquired and may result in minimum order quantities and/or additional charges.

Pickling and Processing	\$/cwt	
	≥.054" to ≤.068" MIN ≥.059" to ≤.073" NOM	>.068" to ≤.266" MIN >.073" to ≤.275" NOM
Pickling Mill Edge (C<.25)	3.00	2.00
Pickling Cut Edge (C<.25)	3.50	2.50
Outside Pickling Mill Edge (>.266" MIN or C>.25) (>.275" NOM or C>.25)	3.00	
Outside Pickling Cut Edge (>.266" MIN or C>.25) (>.275" NOM or C>.25)	3.50	
Slitting - <7" or ≤ .079" or > .380" MIN / ≤ .084" or > .391" NOM	Inquire	
Slitting - ≥7" or Plain cut edge > .079" & ≤ .380" MIN / > .084" & ≤ .391" NOM	2.50	
Rewind - HR Plain to 20" or 24" ID	1.75	

Not all thickness/width/grade combinations are available across our entire dimensional range.

Grade (non-automotive specifications)	\$/cwt
Commercial Steel (CS Types A, B or C)	0.00
1006-1009	0.00
1010-1016	1.50
1017-1023	0.50
Drawing Steel (DS Type A or B)	0.60
Deep Drawing Steel (DDS Type A or B)	2.25
Structural Steels (SS Grade 33,36,40)	0.50
Conversion to Plate A36, 44W, 50W	0.50
OEM/JIS/SAPH/Euronorm (EN) or Modified Specs	Inquire

Effective: January 1<sup>st</sup>, 2018

# Hot Rolled Steel Sheet

Dofasco schedule of price extras, Cdn \$/cwt



High Strength Low Alloy (HSLA) (non-automotive specifications)		\$/cwt
	XK	XF (Formable)
HSLA 40 ksi min yield	1.00	1.50
HSLA 45 ksi min yield	1.25	1.75
HSLA 50 ksi min yield	1.75	2.25
HSLA 55 ksi min yield	2.25	2.50
HSLA 60 ksi min yield	3.25	3.25
HSLA 65 ksi min yield	3.75	3.75
HSLA 70 ksi min yield	4.50	4.50
HSLA 80 ksi min yield	Inquire	6.00

Testing & Certification	\$/cwt
Heat chemical analysis report	0.00
Mechanical properties testing	0.50
Material certification required	0.50

*Testing is performed based on the specification. Price extras apply for testing beyond the specification and for material certification.*

PIW		\$/cwt
	Plain	Pickled
900 and over	0.00	0.00
750 to < 900	0.75	0.75
550 to < 750	1.50	1.50
450 to < 550	2.00	0.50
less than 450	Inquire	Inquire

Order Quantity & Coil Size	\$/cwt
Order quantity less than 2 Master Coils	3.50

*An item is considered one size, grade, destination and delivery date. Certain grades will be subject to heat or tundish lot minimum quantities.*

Surface Requirements	\$/cwt
Semi-critical	1.25

Restricted Tolerances	\$/cwt
Thickness tolerance less than Standard ASTM*	1.50
Width tolerance less than Standard ASTM*	2.50
Flatness tolerance to 1/2 ASTM by tension levelling, pickled only ≤ .266 min / .275 nom	2.00

\* According to ASTM A568 & A635 dimensional tolerance tables

Effective: January 1<sup>st</sup>, 2018

# Cold Rolled Steel Sheet

Dofasco schedule of price extras, Cdn \$/cwt



Thickness and Width (inches)					\$/cwt
MIN GAUGE	NOM GAUGE	30"to <36"	36"to <42"	42"to <48"	48"to 62"
≥. 0.097	≥.100	3.00	2.00	1.50	1.50
.060 - <.097	.062 - <.100	3.00	1.00	0.00	0.00
.028 - <.060	.029 - <.062	3.00	1.50	0.00	0.00
.022 - <.028	.023 - <.029	5.00	4.00	2.50	1.00
.019 - <.022	.020 - <.023	7.00	6.00	4.50	3.00
.017 - <.019	.018 - <.020	8.00	6.00	4.50	3.00
.015 - <.017	.016 - <.018	9.00	7.00	5.50	4.00
.013 - <.015	.014 - <.016	9.00	8.50	7.00	5.00

Unless otherwise specified, Cold Rolled Products are produced to most current ASTM Specifications A1008

Not all thickness/width/grade combinations are available at each production facility across our entire dimensional range.

Non Standard specifications or specifications with modified chemistries, mechanical properties or coatings must be inquired and may result in minimum order quantities and/or additional charges.

Grade (non-automotive specifications)	\$/cwt
Commercial Steel (CS Types A, B or C)	0.00
1006-1009	0.00
1010-1017	2.00
1018-1020	1.35
Drawing Steel (DS Type A or B)	0.60
Deep Drawing Steel (DDS)	1.50
Extra Deep Drawing Steel (EDDS)	2.75
Structural Steels (SS Grade 33)	0.75
OEM/JIS/SAPH/Euronorm (EN) or Modified Specs	Inquire

High Strength Low Alloy (HSLA-non-automotive specifications)	\$/cwt	
	XK	XF (Formable)
HSLA 40 ksi min yield	3.00	3.50
HSLA 45 ksi min yield	3.00	3.50
HSLA 50 ksi min yield	3.75	4.25

Intermediate Temper	\$/cwt
Specified Hardness Range 50-65 RB	0.50
Specified Hardness Range 60-75 RB	1.00
Specified Hardness Range 70-85 RB	1.50

Effective: January 1<sup>st</sup>, 2018

# Cold Rolled Steel Sheet

Dofasco schedule of price extras, Cdn \$/cwt



## UltraVit™ for Vitreous Enameling Steel

\$/cwt

ASTM A424/A424M Type 3 IF

3.50

## Full Hard Reduction

\$/cwt

Full Hard (Rockwell B84 Minimum)

-2.00

## Processing

\$/cwt

Slitting < 7" and ≥ 0.020" min / 0.0215" nom

Inquire

Slitting ≥.7" and ≥ 0.020" min / 0.0215" nom

2.75

Slitting < 7" and < 0.020" min / 0.0215" nom

4.00

Slitting ≥.7" and < 0.020" min / 0.0215" nom

3.75

Rewind

2.75

## Testing & Certification

\$/cwt

Heat chemical analysis report

0.00

Mechanical properties testing

0.50

Material certification required

0.50

*HSLA, SS, and BH grade extras include mechanical properties testing and certification.*

*Testing is performed based on the specification. Price extras apply for testing beyond the specification for material certification.*

## Coil Weight

\$/cwt

NUMBER OF SPLITS FROM MASTER COIL

CUSTOMER'S NEGOTIATED PIW RANGE

PIW EXTRA

Nil

900 and over

0.00

Nil

750 to < 900

0.75

Nil

550 to < 750

1.50

2

450 to < 550

0.50

2

375 to < 450

1.50

3 or more

< 375

1.50

## Order Quantity & Coil Size

\$/cwt

Order quantity less than 2 Master Coils

2.25

*An item is considered one size, grade, destination and delivery date.*

Effective: January 1<sup>st</sup>, 2018

# Cold Rolled Steel Sheet

Dofasco schedule of price extras, Cdn \$/cwt



Surface Requirements	\$/cwt
Semi-critical (required for prepainted product)	1.25
Surface Critical	3.00

Finish Requirements	\$/cwt
Rough matte (typical Ra: 60-125)	0.00
Regular matte (typical Ra: 30-80)	0.00
Light matte (typical Ra: 30-55)	0.00
Ultra light matte (typical Ra: 20-35)	1.50
Lustre (semi bright) (typical Ra: 20 max)	2.25

Treatment Requirements	\$/cwt
Mill Oil	0.00
Dry (no rust claims on dry)	1.00
Prelube coated (from approved list)	0.60

Restricted Tolerances	\$/cwt
Thickness tolerance less than standard ASTM	1.25
Width tolerance less than standard ASTM	2.75
Flatness tolerance half ASTM	1.50
Flatness tolerance to quarter ASTM by tension levelling	2.75

*According to ASTM Thickness Tolerance Tables revised version ASTM A568/A568M.*

# Galvanized & Galvanneal Steel Sheet

Dofasco schedule of price extras, Cdn \$/cwt



Thickness and Width (inches)								\$/cwt
MIN GAUGE	NOM GAUGE	> 30" TO <35"	35" TO 40"	> 40" TO 45"	> 45" TO 50"	>50" TO 55"	>55" TO 60"	>60" TO 62"
≥.079	≥.080	3.30	2.25	0.50	0.00	0.00	0.00	Inquire
.028 - <.079	.029 - <.080	3.25	1.75	0.00	0.00	0.00	0.00	Inquire
.022 - <.028	.023 - <.029	4.30	3.25	1.50	1.50	1.50	1.50	Inquire
.019 - <.022	.020 - <.023	6.00	3.75	2.00	2.00	2.00	2.00	2.00
.017 - <.019	.018 - <.020	7.50	5.00	2.75	2.75	2.75	2.75	2.75
.015 - <.017	.016 - <.018	9.00	7.50	3.50	3.50	3.50	3.50	Inquire
.014 - <.015	.015 - <.016	10.00	8.00	4.00	4.00	4.00	Inquire	N/A
.013 - <.014	.014 - <.015	10.50	9.00	6.00	4.50	4.50	N/A	N/A
.012 - <.013	.013 - <.014	11.00	9.50	6.50	5.00	Inquire	N/A	N/A
.011 - <.012	.012 - <.013	11.50	10.00	7.00	5.50	N/A	N/A	N/A
.010 - <.011	.011 - <.012	12.00	10.50	7.50	Inquire	N/A	N/A	N/A
.009 - <.010	.010 - <.011	12.50	11.00	Inquire	N/A	N/A	N/A	N/A

Unless otherwise specified, Galvanize & Galvanneal steel sheet produced to ASTM specifications (A653).

Not all thickness/width/grade combinations are available across our entire dimensional range.

Non-standard specifications or specifications with modified chemistries, mechanical properties or coatings must be inquired and may result in specific order quantities and/or additional charges.

Grade (non-automotive specifications)	\$/cwt
Commercial Steel (CS Types A, B or C)	0.00
1006-1009	0.00
Forming Steel (FS Types A or B)	0.60
Deep Drawing Steel (DDS)	1.50
Extra Deep Drawing Steel (EDDS)	2.75
High Strength Deep Drawing Steel (HSDDS)	4.50
OEM/JIS/SAPH/Euronorm (EN) or Modified Specs	Inquire

Effective: January 1<sup>st</sup>, 2018

# Galvanized & Galvanneal Steel Sheet

Dofasco schedule of price extras, Cdn \$/cwt



High Strength Low Alloy (HSLA)		\$/cwt
(non-automotive specifications)	XK	XF (Formable)
HSLA 40 ksi min yield	Inquire	3.90
HSLA 50 ksi min yield	3.90	4.40
HSLA 55 ksi min yield	4.40	Inquire
HSLA 60 ksi min yield	Inquire	4.90
HSLA 80 ksi min yield*	Inquire	7.50

\*HSLA 80 ksi min yield available as Galvanize only.

Structural Steels	\$/cwt
Grade 33 (230)	0.00
Grade 37 (255)	0.25
Grade 40 (275)	0.75
Grade 50 (340) Class 1 or 2*	1.50
Grade 50 (340) Class 3*	2.00
Grade 80 (550)	0.50

\*Grade 50 available as Galvanize only.

Processing	\$/cwt
Slitting or Side Trimming $\geq 7"$ & $\geq 0.020"$ min / 0.0215" nom	2.75
Slitting or Side Trimming $\geq 7"$ Under 0.020" min / 0.0215" nom	3.75
Slitting or Side Trimming $< 7"$	Inquire

Testing & Certification	\$/cwt
Heat chemical analysis report	0.00
Mechanical properties testing	0.50
Material certification required	0.50
Stencilling (e.g. CSP - Culvert)	0.15

Testing is performed per the specification. Price extras apply for testing beyond the specification and for material certification.

# Galvanized & Galvanneal Steel Sheet

Dofasco schedule of price extras, Cdn \$/cwt



Coil Weight		\$/cwt
NUMBER OF SPLITS FROM MASTER COIL	CUSTOMER'S NEGOTIATED PIW RANGE	PIW EXTRA
Nil	900 and over	0.00
Nil	750 to < 900	0.75
Nil	550 to < 750	1.50
2	450 to < 550	0.50
2	375 to < 450	1.50
3 or more	< 375	1.50

Order Quantity & Coil Size Extras	\$/cwt
Order quantity less than 2 Master Coils	2.25
<i>*An item is considered one size, grade, destination and delivery date.</i>	

Surface Requirements	\$/cwt
Standard unexposed	0.00
Semi-critical	1.50
PFQ (other than Baycoat)	1.50
PFQ (Baycoat only)	0.50
Surface critical	3.00
Auto Exposed coil	Inquire
Auto Exposed for Blanking	Inquire

Effective: January 1<sup>st</sup>, 2018

# Galvanized & Galvanneal Steel Sheet

Dofasco schedule of price extras, Cdn \$/cwt



Treatment Requirements	\$/cwt
Oil (type not specified)	0.00
Oil (type specified from approved list)	0.60
Prelube (type specified from approved list)	0.60
E-Passivation® (RoHS Compliant) $\geq 0.030$ " min / $.032$ " nom	0.25
E-Passivation® (RoHS Compliant) $< 0.030$ " min / $.032$ " nom	0.50
Lustrelok® Acrylic coating $\geq .030$ " min / $.032$ " nom	0.75
Lustrelok® Acrylic coating $< .030$ " min - $.022$ " min / $< .032$ " nom - $.0235$ " nom	1.00
Lustrelok® Acrylic coating $< .022$ " min - $.018$ " min / $< .0235$ " nom - $.0195$ " nom	1.25
Lustrelok® Acrylic coating $< .018$ " min - $.015$ " min / $< .0195$ " nom - $.0165$ " nom	1.50
Lustrelok® Acrylic coating $< .015$ " min - $.0142$ " min / $< .0165$ " nom - $.0157$ " nom	2.00
Lustrelok® Acrylic coating $< .0142$ " min / $< .0157$ " nom	2.50

Restricted Tolerances	\$/cwt
Thickness tolerance less than standard ASTM	1.25
Restricted Coating weight	0.50
Width tolerance less than standard ASTM	2.75
Flatness tolerance half ASTM	1.50
Flatness tolerance to quarter ASTM by tension levelling	2.75
Architectural Panel Rolling Practice	1.75

According to ASTM Dimensional Tolerance Tables (A924).

Effective: January 1<sup>st</sup>, 2018

# Galvanized & Galvanneal Steel Sheet

Dofasco schedule of price extras, Cdn \$/cwt



Coating Weight									\$/cwt
SPECIFIED MINIMUM THICKNESS	SPECIFIED NOMINAL THICKNESS	Z001- Z100 (G30) ZF001 40A40A	Z120 (G40) ZF75 - ZF120 45A45A 50A50A 60G60G 70G70G	Z180 (G60) ZF180 55A55A 90G90G 98G98G	Z275 (G90)	Z350 (G115)	Z450 (G140)	Z600 (G210)	Z700 Z720 (G235)
≥.130	≥.134	1.65	1.65	2.10	2.95	3.85	5.00	6.50	7.65
.085 - <.130	.087 - <.134	2.10	2.10	2.70	4.00	5.15	6.50	8.70	10.10
.060 - <.085	.062 - <.087	2.95	2.95	4.05	5.70	7.45	9.60	12.65	14.30
.044 - <.060	.045 - <.062	4.15	4.15	5.55	7.90	10.25	13.20	17.45	20.35
.036 - <.044	.037 - <.045	4.55	4.55	6.40	9.10	13.20	16.95	20.85	26.25
.032 - <.036	.033 - <.037	5.05	5.05	7.10	10.20	13.25	17.10	23.40	27.25
.028 - <.032	.029 - <.033	5.55	5.55	7.90	11.20	14.60	17.20	25.75	30.05
.025 - <.028	.026 - <.029	6.40	6.40	9.05	12.95	16.80	19.90	29.60	34.60
.022 - <.025	.023 - <.026	7.00	7.00	10.00	14.30	18.45	21.95	32.60	38.20
.020 - <.022	.021 - <.023	7.90	7.90	11.20	15.95	20.75	24.60	37.95	42.80
.018 - <.020	.019 - <.021	8.80	8.80	12.45	17.70	22.20	27.50	42.30	47.65
.016 - <.018	.017 - <.019	9.70	9.70	13.70	19.55	24.45	30.15	46.60	52.50
.015 - <.016	.016 - <.017	10.50	10.50	14.75	21.15	26.45	32.60	52.15	56.80
.014 - <.015	.015 - <.016	11.10	11.10	15.60	23.20	27.95	34.50	55.25	60.00
.013 - <.014	.014 - <.015	13.10	13.85	16.55	24.60	N/A	N/A	N/A	N/A
.012 - <.013	.013 - <.014	13.90	14.75	17.65	26.25	N/A	N/A	N/A	N/A
.011 - <.012	.012 - <.013	14.90	15.75	18.85	28.05	N/A	N/A	N/A	N/A
.010 - <.011	.011 - <.012	16.00	16.95	20.25	30.10	N/A	N/A	N/A	N/A
.009 - <.010	.010 - <.011	17.35	18.25	21.95	32.55	N/A	N/A	N/A	N/A

Effective: January 1<sup>st</sup>, 2018

# Galvalume™ Steel Sheet

Dofasco schedule of price extras, Cdn \$/cwt



Thickness and Width (inches)							\$/cwt
MIN GAUGE	NOM GAUGE	> 30" TO <35"	35" TO 40"	> 40" TO 45"	> 45" TO 50"	>50" TO 55"	>55" TO 60.5"
≥.079	≥.080	Inquire	Inquire	Inquire	Inquire	Inquire	Inquire
.028 - <.079	.029 - <.080	3.25	1.75	0.00	0.00	0.00	0.00
.022 - <.028	.023 - <.029	4.30	3.25	1.50	1.50	1.50	1.50
.019 - <.022	.020 - <.023	6.00	3.75	2.00	2.00	2.00	2.00
.017 - <.019	.018 - <.020	7.50	5.00	2.75	2.75	2.75	2.75
.015 - <.017	.016 - <.018	9.00	7.50	3.50	3.50	3.50	Inquire
.014 - <.015	.015 - <.016	10.00	8.00	4.00	4.00	4.00	Inquire
.013 - <.014	.014 - <.015	10.50	9.00	6.00	4.50	4.50	N/A
.012 - <.013	.013 - <.014	11.00	9.50	6.50	5.00	Inquire	N/A
.011 - <.012	.012 - <.013	Inquire	Inquire	Inquire	Inquire	N/A	N/A
.010 - <.011	.011 - <.012	Inquire	Inquire	Inquire	Inquire	N/A	N/A
.009 - <.010	.010 - <.011	Inquire	Inquire	Inquire	N/A	N/A	N/A

Unless otherwise specified, Galvalume™ steel sheet produced to current ASTM specifications (A792).

Not all thickness/width/grade combinations are available across our entire dimensional range.

Non-standard specifications or specifications with modified chemistries, mechanical properties or coatings must be inquired and may result in specific order quantities and/or additional charges.

Grade (non-automotive specifications)	\$/cwt
Commercial Steel (CS Types A, B or C)	0.00
1006-1009	0.00
Forming Steel (FS Types A or B)	0.60
OEM/JIS/SAPH/Euronorm (EN) or Modified Specs	Inquire

Structural Steels (non-automotive specifications)	\$/cwt
Grade 33 (230)	0.00
Grade 37 (255)	0.25
Grade 40 (275)	0.75
Grade 50 (340) Class 1 or 2	1.50
Grade 50 (340) Class 3	2.00
Grade 80 (550)	0.50

Effective: January 1<sup>st</sup>, 2018

# Galvalume™ Steel Sheet

Dofasco schedule of price extras, Cdn \$/cwt



Processing	\$/cwt
Slitting or Side Trimming $\geq 7"$ & $\geq 0.020"$ min / 0.0215" nom	2.75
Slitting or Side Trimming $\geq 7"$ Under 0.020" min / 0.0215" nom	3.75
Slitting or Side Trimming $< 7"$	Inquire

Testing & Certification	\$/cwt
Heat chemical analysis report	0.00
Mechanical properties testing	0.50
Material certification required	0.50

*Testing is performed per the specification. Price extras apply for testing beyond the specification and for material certification.*

Coil Weight		\$/cwt
NUMBER OF SPLITS FROM MASTER COIL	CUSTOMER'S NEGOTIATED PIW	PIW EXTRA
Nil	900 and over	0.00
Nil	750 to < 900	0.75
Nil	550 to < 750	1.50
2	450 to <550	0.50
2	375 to < 450	1.50
3 or more	< 375	1.50

Order Quantity & Coil Size Extras	\$/cwt
Order quantity less than 2 Master Coils	2.25

*\*An item is considered one size, grade, destination and delivery date.*

# Galvalume™ Steel Sheet

Dofasco schedule of price extras, Cdn \$/cwt



Surface Requirements	\$/cwt
Standard unexposed	0.00
Semi-critical	1.50
PFQ (other than Baycoat)	1.50
PFQ (Baycoat only)	0.50
Surface critical	3.00

Treatment Requirements	\$/cwt
Oil (type not specified)	0.00
Oil (type specified from approved list)	0.60
Prelube (type specified from approved list)	0.60
Galvalume Plus® - Acrylic coating $\geq .030$ " min / $.032$ " nom	0.75
Galvalume Plus® - Acrylic coating $< .030$ " min - $.022$ " min / $< .032$ " nom - $.0235$ " nom	1.00
Galvalume Plus® - Acrylic coating $< .022$ " min - $.018$ " min / $< .0235$ " nom - $.0195$ " nom	1.25
Galvalume Plus® - Acrylic coating $< .018$ " min - $.015$ " min / $< .0195$ " nom - $.0165$ " nom	1.50
Galvalume Plus® - Acrylic coating $< .015$ " min - $.0142$ " min / $< .0165$ " nom - $.0157$ " nom	2.00
Galvalume Plus® - Acrylic coating $< .0142$ " min / $< .0157$ " nom	2.50

Restricted Tolerances*	\$/cwt
Thickness tolerance less than standard ASTM	1.25
Restricted coating weight	0.50
Width tolerance less than standard ASTM	2.75
Flatness tolerance half ASTM	1.50
Flatness tolerance to quarter ASTM by tension levelling	2.75
Architectural Panel Rolling Practice	1.75

\*according to ASTM Dimensional Tolerance Tables (A924).

Effective: January 1<sup>st</sup>, 2018

# Galvalume™ Steel Sheet

Dofasco schedule of price extras, Cdn \$/cwt



Coating Weight					\$/cwt
SPECIFIED MINIMUM THICKNESS	SPECIFIED NOMINAL THICKNESS	AZM100 (AZ35)	AZM150 (AZ50)	AZM165 (AZ55)	AZM180 (AZ60)
.078 - <.090	.080 - <.092	Inquire	Inquire	Inquire	Inquire
.060 - <.078	.062 - <.080	2.75	3.95	4.40	4.80
.044 - <.060	.045 - <.062	3.65	5.25	5.80	6.25
.036 - <.044	.037 - <.045	4.80	5.60	6.15	6.65
.032 - <.036	.033 - <.037	5.00	5.85	6.40	7.00
.028 - <.032	.029 - <.033	5.65	6.60	7.25	7.95
.025 - <.028	.026 - <.029	6.40	7.45	8.20	8.95
.022 - <.025	.023 - <.026	7.20	8.40	9.30	10.10
.020 - <.022	.021 - <.023	8.10	9.45	10.35	11.30
.018 - <.020	.019 - <.021	8.90	10.45	11.45	12.55
.016 - <.018	.017 - <.019	9.90	11.65	12.80	14.00
.015 - <.016	.016 - <.017	10.90	12.80	14.05	15.35
.014 - <.015	.015 - <.016	11.50	13.55	14.95	16.30
.013 - <.014	.014 - <.015	13.35	15.60	N/A	N/A
.012 - <.013	.013 - <.014	14.50	16.95	N/A	N/A
.011 - <.012	.012 - <.013	Inquire	Inquire	N/A	N/A
.010 - <.011	.011 - <.012	Inquire	Inquire	N/A	N/A
.009 - <.010	.010 - <.011	Inquire	Inquire	N/A	N/A

Other coating designations available - Inquire.

## Tin Mill Products

Dofasco schedule of price extras, US \$



### All Tin Mill Products Prices are expressed in US dollars

#### Products Offered

Black Plate – As Rolled, Single & Double Reduced  
Black Plate – Full Finish, Single & Double Reduced  
Electrolytic Chromium Coated Steel, Single & Double Reduced  
Electrolytic Tin Plate, Single & Double Reduced

#### Coil Weight

#### \$/Base Box

12,000 lbs and over	Base
Under 12,000 lbs to 6,000 lbs	1.65

#### Quantity

#### \$/Base Box

80,000 lbs. and over	Base
Under 80,000 lbs. to 40,000 lbs.	1.25

#### Quality

#### \$/Base Box

Non Earing Quality	0.65
Type K or J Plate	2.40
DRD (Draw/Redraw)*	1.95
Special Chemistry Requirements	2.75
Clean Steel	2.75

\*When height of can exceeds diameter

Clean Steel Practice is required on any Tin Mill Product application where the manufacture of the end product requires extremely clean steel internal steel characteristics due to severe shaping, drawing and/or ironing. Examples of such products include drawn and ironed cans, easy open ends, maleis®, and oil filter shells

Effective: January 1<sup>st</sup>, 2018

## Tin Mill Products

Dofasco schedule of price extras, US \$



Base Weight							
Dimension Extras Single & Double Reduced							
Base Weight	\$/Base Box	Base Weight	\$/Base Box	Base Weight	\$/Base Box	Base Weight	\$/Base Box
54*	Inquire	75	8.00	96	16.40	117	24.80
55*	Base	76	8.40	97	16.80	118	25.20
56*	0.40	77	8.80	98	17.20	119	25.60
57*	0.80	78	9.20	99	17.60	120	26.00
58*	1.20	79	9.60	100	18.00	121	26.40
59*	1.60	80	10.00	101	18.40	122	26.80
60*	2.00	81	10.40	102	18.80	123	27.20
61*	2.40	82	10.80	103	19.20	124	27.60
62*	2.80	83	11.20	104	19.60	125	28.00
63*	3.20	84	11.60	105	20.00	126	28.40
64*	3.60	85	12.00	106	20.40	127	28.80
65	4.00	86	12.40	107	20.80	128**	29.20
66	4.40	87	12.80	108	21.20	129**	29.60
67	4.80	88	13.20	109	21.60	130**	30.00
68	5.20	89	13.60	110	22.00	131**	30.40
69	5.60	90	14.00	111	22.40	132**	30.80
70	6.00	91	14.40	112	22.80	133**	31.20
71	6.40	92	14.80	113	23.20	134**	31.60
72	6.80	93	15.20	114	23.60	135**	32.00
73	7.20	94	15.60	115	24.00		
74	7.60	95	16.00	116	24.40		

^ For capability and pricing outside of base weights listed please inquire

\* Double Reduced Only

\*\* Single Reduced Only

Effective: January 1<sup>st</sup>, 2018

## Tin Mill Products

Dofasco schedule of price extras, US \$



Coating Weight	\$/Base Box
10 *	1.06
15 *	1.70
20	2.33
25	3.25
50 **	7.68
20/10 *	1.70
20/15 *	1.92
50/10 **	4.11
50/20 **	4.97
50/25 **	5.41
Chromium Coated	0.53

\* The coatings less than No. 20, specified as reflowed, should not be used where appropriate or aesthetics are critical.

\*\*Any coating code with 50 please inquire (thickness restrictions)

Special Processing	\$/Base Box
Close Slit (-0+1/16")	0.55
Ultra Close Slit (-0+1/32")	1.05
Restricted Side Trim Tolerances	1.05

Packaging	As Below
Coil Cores (\$ per coil)	15.85
Coil I.D. >16" (\$ per base box)	1.75

### Coating Notes

Tin coating weights less than No. 25 are intended for non-soldered applications and do not carry or imply any guarantee of solderability.

Tin coating wrap-around is an inherent condition of the plating process where tin coating, at or near the strip edge, is significantly greater than the specified nominal coating. This condition is most prominent on the light side.

Other tin coating weights are subject to inquiry.

Coil Width	\$/Base Box
≥ 33.5	Base
30.5 - 33.499	1.10
29.00 - 30.499	2.92
Other	Inquire

General	\$/Base Box
No Welds	0.65
Testing and / or Sampling	0.65

Effective: January 1<sup>st</sup>, 2018

# Electrolytic Tin Coated & Chrome Coated Sheet

Dofasco schedule of price extras, US \$/cwt



## Products Offered

Electrolytic Tin Coated Sheet  
Electrolytic Chrome Coated Sheet

## Thickness and Width (inches) \$/cwt

Nom. Thickness	Widths		
	28.0 - <30.5	30.5 - <33.5	≥33.5
.0284 - .0300	2.50	2.00	1.75
.0251 - .0283	3.00	2.50	2.25
.0225 - .0250	3.50	3.00	2.50
.0195 - .0224	4.00	3.50	3.25
.0172 - .0194	4.75	4.25	4.00
.0150 - .0171	6.00	5.00	4.50

## Coil Weight \$/cwt

12,000 lbs. and over Base  
Under 12,000 lbs. to 6,000 lbs 2.00

## Quantity \$/cwt

80,000 lbs. and over Base  
Under 80,000 lbs. to 40,000 lbs 1.25

## Quality \$/cwt

Clean Steel Practice 2.75  
Commercial Steel (CS) Base  
Drawing Steel (DS) 0.60  
DDS 1.50  
Structural Steel 0.75

## Coating Weight Extra \$/cwt

10 *	0.77
20	1.52
25	1.96
50 **	6.03
Chromium Coated	0.40

Other tin coating weights are subject to inquiry.

\* If these coatings are specified as reflowed, they should not be used where appearance or aesthetics are critical.

\*\* Any coating code with 50 please inquire (thickness restrictions)

## General \$/cwt

No Welds 0.55  
Testing or Certification 0.55  
Restricted Thickness Tolerance Inquire  
Coil I.D. > 16.5" 1.75

Effective: January 1<sup>st</sup>, 2018

## General Pricing Notes

Tin Mill Products & Electrolytic Tin Coated & Chrome Coated Sheets



- 1 ArcelorMittal Dofasco Terms and Conditions of Sale, General Pricing Guidelines and the Price Book are available for review at <https://ec.dofasco.ca>
- 2 All prices are in US dollars per base box, FOB producing mill, with no freight equalization.
- 3 All prices are in effect at time of shipment.
- 4 All prices are subject to change without notice.
- 5 All initial orders require metallurgical assessment to determine mill acceptance;
  - a) Not all thickness/width/grade combinations are available across our entire dimensional range.
  - b) Non-standard specifications or specifications with modified chemistries, mechanical properties or coatings must be reviewed and may result in specific order quantities and/or additional charges.
  - c) Certain grades will be subject to minimum heat lot order quantities.
  - d) An item is considered one size and grade, and coating (if applicable) for delivery to one destination at one time.
  - e) Grade extras include test reports where required by specification designation
- 6 Coils are supplied with cut edge only.
- 7 Standard coil ID is 16".
- 8 Custom packaging charges will be additional to PIW charges if applicable. Please inquire for custom packaging price extras.

## Pre-Coat Products

Dofasco schedule of price extras, Cdn \$/cwt



<b>1.0</b>	<b>Item Quantities</b>	
1.1	Item Quantity Discounts and Extras	25
<b>2.0</b>	<b>Slitting</b>	
		25
<b>3.0</b>	<b>Packaging</b>	
3.1	Packaging Extras	26
<b>4.0</b>	<b>Coil Weights</b>	
		26
<b>5.0</b>	<b>Non-Standard Processing</b>	
		26
<b>6.0</b>	<b>10000 Series, Perspectra Plus Series™, Perspectra Metallics Series™, WeatherXL™, Exterior Polyester, Fluorocarbon, and SMP Paint Prices</b>	
6.1	Hot Dip Galvanized Substrate – Topcoat / Primer / Washcoat	27
6.2	Hot Dip Galvanized – Topcoat / Primer / Primer / Washcoat	28
6.3	Galvalume™ Substrate – Topcoat / Primer / Washcoat	29
6.4	Galvalume™ Substrate – Topcoat / Primer / Primer / Washcoat	30
6.5	Topcoat Colours and Paint Prices	
6.5.1	10000 Series	31
6.5.2	Perspectra Plus Series™	32
6.5.3	Perspectra Metallics Series™	33
6.5.4	Exterior Polyester	33
<b>7.0</b>	<b>Barrier Series and Solano® Paint System Prices</b>	
7.1	Galvanized Barrier Series and Solano®	34
7.2	Barrier Series Topcoat Colours and Paint Prices	35
7.3	Solano® Topcoat Colours and Paint Prices	36
<b>8.0</b>	<b>Metallic and Elite Series and TagTough® Paint System Prices</b>	
8.1	Galvanized – Metallic and Elite Series and TagTough®	37
8.2	Galvalume™ – Metallic and Elite Series and TagTough®	38
8.3.1	Metallic and Elite Series Topcoat Colours and Paint Prices	39
8.3.2	TagTough® Paint Prices (Graffiti Resistant Coating)	39

For Pricing on Granite™ Deep Mat, Mica PVDF, Polyurethane, Ruffkote, Interior Polyester, Appliance Polyester or any others, please contact your ArcelorMittal Dofasco Sales Representative

# Pre-Coat Products

Dofasco schedule of price extras, Cdn \$/cwt



## 1.0 Item Quantities

An “item” is considered to be a distinct “Baycoat shop order” of like parameters through the paint line (i.e. one dimensional size, and one grade and quality, one topcoat colour and film thickness, one backcoat or washcoat for delivery at one time to one destination).

Item Master Coil Width is defined as the width of the steel through the paint line.

## 1.1 Item Quantity Discounts and Extras

\$/cwt

Based on lbs ordered, base price per 100 lbs is adjusted as per the table below.

PAINT SYSTEM / QC	POUNDS ORDERED				
	< 20,000	≥ 20,000 < 40,000	≥ 40,000 < 80,000	≥ 80,000 < 200,000	≥ 200,000
Barrier Series / 2 Pass Metallic and Elite Series / Solano® / TagTough®	24.00	3.25	0.00	-1.25	-2.50
Primers / Backers / Phenolic / Bus Primer / QCs 00801, 05754, 07757, 05340	24.00	3.25	0.00	0.00	0.00
All Other Paint Systems & QCs including 10000 Series, Perspectra Plus Series™, Perspectra Metallics Series™, WeatherXL™, Exterior Polyester, Fluorocarbon, and SMP	24.00	3.25	0.00	-0.50	-1.00

*\*For 35" to 39.999" wide master coils the item quantity extra will not apply if orders are placed in quantities of 1 x 1000 x Master Coil Width. Orders must be in whole number multiples of 1000 x Master Coil Width.*

## 2.0 Slitting

\$/cwt

The extras listed below are to be added to the Master Coil base paint prices. All slitting extras include skeleton platforms, spacers, and single paper wrap if required.

MINIMUM GAUGE	ORDERED WIDTH	
	< 7"	≥ 7"
≤ 0.012"	8.00	6.00
> 0.012" to < 0.020"	7.00	4.75
≥ 0.020"	6.00	4.50

Effective: January 1<sup>st</sup>, 2018

## Pre-Coat Products

Dofasco schedule of price extras, Cdn \$/cwt



### 3.0 Packaging – In Addition To Coil Weight Extras in Section 4.0 \$/cwt

Standard packaging is coil eye vertical on a skeleton platform, single paper wrapped.

SPECIFIED PACKAGE WEIGHT	ORDERS ≥ 24"	ORDERS < 24"
10,000 lbs. & over	Nil	0.25
Under 10,000 to 6,000 lbs.	0.50	0.75
Under 6,000 to 3,000 lbs.	1.00	2.50
Under 3,000 lbs.	2.00	3.00

*Fiber coreliners are used on full-width product 0.032" and lighter. Fiber coreliners are not returnable*

Packaging prices are driven by the materials used and the labour required to prepare lifts for shipment. Small lifts incur much greater costs per cwt for the same packaging configuration/code. Special packaging that requires spacers, sidewall protection, shrouding and ID protection is subject to additional costs. Please consult with your sales account personnel regarding customized packaging and associated price extras.

### 3.1 Packaging Extras – In Addition to Standard Packaging Extras in Section 3.0 \$/cwt

SPECIFIED PACKAGE WEIGHT (\$/CWT)	SPACERS	SIDEWALL PROTECTION OR SHROUDING	ID PROTECTION (EG. CORE LINERS)
>20,000 lbs	0.20	0.05	0.05
20,000 to 10,000 lbs	0.40	0.10	0.10
Under 10,000 to 6,000 lbs	0.60	0.20	0.20
Under 6,000 to 3,000 lbs.	0.60	0.20	0.20
Under 3,000 lbs	0.60	0.20	0.20

Please inquire for pricing on non-standard packaging.

### 4.0 PIW Extra's \$/cwt

PIW price extras are based on the customized finished weight.

PIW price extras are based on painted PIW.

POUNDS PER INCH OF WIDTH	ORDERED WIDTH		
	24" and over	under 24" to over 12"	12" and under
200 lbs. and over	none	0.25	0.50
under 200 lbs. to 100 lbs. Incl.	0.10	0.50	0.75
under 100 lbs. to 75 lbs. Incl.	0.25	0.75	1.00

### 5.0 Non-Standard Processing \$/cwt

All processing besides slitting is on an inquire basis only.

Effective: January 1<sup>st</sup>, 2018

## Pre-Coat Products

Dofasco schedule of price extras, Cdn \$/cwt



**6.0 10000 Series, Perspectra Plus Series™, Perspectra Metallics Series™, WeatherXL™, Exterior Polyester, Fluorocarbon, and SMP Paint Prices \$/cwt**

**6.1 10000 Series, Perspectra Plus Series™, Perspectra Metallics Series™ WeatherXL™, Exterior Polyester, Fluorocarbon, and SMP Paint Prices (HDG - TPW) \$/cwt**

### Galvanized Substrate - Zinc Phosphate Pretreatment

#### TOPCOAT/PRIMER/WASH

Minimum Gauge	Nominal Gauge	Gauge Factor	Width				
			24" TO 30"	Over 30" To Under 35.4"	35.4" To 40"	Over 40" To 50"	Over 50" To 60"
> 0.0454"	>0.0514"	0.33	8.94	8.14	7.40	6.90	-
0.0425" - 0.0454"	0.0485" - 0.0514"	0.38	9.21	8.48	7.80	7.26	-
0.0370" - 0.0424"	0.0425" - 0.0484"	0.42	9.51	8.82	8.17	7.66	-
0.0325" - 0.0369"	0.0375" - 0.0424"	0.48	9.72	9.06	8.44	7.94	7.14
0.0305" - 0.0324"	0.0345" - 0.0374"	0.53	9.94	9.31	8.72	8.24	7.50
0.0275" - 0.0304"	0.0315" - 0.0344"	0.58	10.12	9.51	8.92	8.45	7.76
0.0245" - 0.0274"	0.0285" - 0.0314"	0.63	10.30	9.69	9.11	8.65	7.99
0.0215" - 0.0244"	0.0255" - 0.0284"	0.71	10.46	9.86	9.29	8.85	8.22
0.0195" - 0.0214"	0.0225" - 0.0254"	0.80	11.06	10.50	10.04	9.57	9.13
0.0175" - 0.0194"	0.0205" - 0.0224"	0.89	11.28	10.79	10.33	9.88	9.49
0.0165" - 0.0174"	0.0195" - 0.0204"	0.95	11.37	10.88	10.42	9.97	9.59
0.0155" - 0.0164"	0.0185" - 0.0194"	1.00	11.58	11.10	10.61	10.15	9.67
0.0145" - 0.0154"	0.0175" - 0.0184"	1.05	11.68	11.19	10.71	10.24	9.76
0.0135" - 0.0144"	0.0165" - 0.0174"	1.13	11.78	11.28	10.81	10.34	9.86
0.0125" - 0.0134"	0.0155" - 0.0164"	1.20	11.87	11.39	10.90	10.43	9.97
0.0115" - 0.0124"	0.0145" - 0.0154"	1.28	12.07	11.48	10.99	10.52	10.06
0.0105" - 0.0114"	0.0135" - 0.0144"	1.37	12.18	11.69	11.18	10.71	10.24
0.0095" - 0.0104"	0.0125" - 0.0134"	1.47	12.42	11.93	11.41	10.92	10.45
0.0085" - 0.0094"	0.0115" - 0.0124"	1.59	12.68	12.17	11.64	11.15	10.66
0.0075" - 0.0084"	0.0105" - 0.0114"	1.74	12.94	12.42	11.89	11.37	10.88
0.0065" - 0.0074"	0.0095" - 0.0104"	1.91	13.20	12.67	12.13	11.60	11.10
< 0.0065"	< 0.0095"		Inquire	Inquire	Inquire	Inquire	Inquire

Zinc Phosphate Pretreatment included in price; except for Exterior Polyester which will have the thickness & width extra reduced by \$0.55.

#### Price Calculation

Base Price (From Above Table): \_\_\_\_\_ (A)  
 Paint Series-specific Topcoat Price Factor (from Section 6.5): \_\_\_\_\_ (B)  
 Paint Film Price: (B) \_\_\_\_\_ X Gauge Factor \_\_\_\_\_ = \_\_\_\_\_ (C)  
 Total Paint Price Per 100 lbs: \_\_\_\_\_ (A + C)

**\*\*Please inquire for gauges and widths not shown.**

#### NOTE:

- 1) Perspectra Plus Series™, Perspectra Metallics Series™ and 10,000 Series colours cannot be combined.
- 2) Standard washcoats are QC543 and QC4614. For External Polyester only, QC458 is also a standard washcoat. For all non-standard washcoats, add \$0.46/cwt.

Effective: January 1<sup>st</sup>, 2018

# Pre-Coat Products

Dofasco schedule of price extras, Cdn \$/cwt



## 6.2 10000 Series, Perspectra Plus Series™, Perspectra Metallics Series™ WeatherXL™, Exterior Polyester, Fluorocarbon, and SMP Paint Prices (HDG – TPPW) \$/cwt

### Galvanized Substrate – Zinc Phosphate Pretreatment

Topcoat/Primer/Primer/Wash or Topcoat/Primer/Primer/Backcoat							
Minimum Gauge	Nominal Gauge	Gauge Factor	Width				
			24" TO 30"	Over 30" To Under 35.4"	35.4" To 40"	Over 40" To 50"	Over 50" To 60"
> 0.0454"	>0.0514"	0.33	9.80	9.05	8.27	7.72	-
0.0425" - 0.0454"	0.0485" - 0.0514"	0.38	10.09	9.33	8.60	8.03	-
0.0370" - 0.0424"	0.0425" - 0.0484"	0.42	10.39	9.67	8.98	8.44	-
0.0325" - 0.0369"	0.0375" - 0.0424"	0.48	10.61	9.92	9.25	8.73	7.90
0.0305" - 0.0324"	0.0345" - 0.0374"	0.53	10.85	10.19	9.56	9.03	8.27
0.0275" - 0.0304"	0.0315" - 0.0344"	0.58	11.03	10.38	9.76	9.26	8.53
0.0245" - 0.0274"	0.0285" - 0.0314"	0.63	11.21	10.57	9.96	9.46	8.76
0.0215" - 0.0244"	0.0255" - 0.0284"	0.71	11.39	10.76	10.14	9.66	9.01
0.0195" - 0.0214"	0.0225" - 0.0254"	0.80	12.00	11.45	10.93	10.40	9.93
0.0175" - 0.0194"	0.0205" - 0.0224"	0.89	12.24	11.72	11.22	10.70	10.30
0.0165" - 0.0174"	0.0195" - 0.0204"	0.95	12.36	11.83	11.31	10.81	10.40
0.0155" - 0.0164"	0.0185" - 0.0194"	1.00	12.58	12.05	11.52	11.01	10.50
0.0145" - 0.0154"	0.0175" - 0.0184"	1.05	12.68	12.16	11.62	11.10	10.60
0.0135" - 0.0144"	0.0165" - 0.0174"	1.13	12.78	12.27	11.73	11.21	10.70
0.0125" - 0.0134"	0.0155" - 0.0164"	1.20	12.89	12.37	11.84	11.32	10.80
0.0115" - 0.0124"	0.0145" - 0.0154"	1.28	13.11	12.47	11.94	11.42	10.90
0.0105" - 0.0114"	0.0135" - 0.0144"	1.37	13.22	12.69	12.15	11.63	11.11
0.0095" - 0.0104"	0.0125" - 0.0134"	1.47	13.49	12.95	12.39	11.87	11.34
0.0085" - 0.0094"	0.0115" - 0.0124"	1.59	13.76	13.21	12.64	12.10	11.56
0.0075" - 0.0084"	0.0105" - 0.0114"	1.74	14.03	13.47	12.89	12.34	11.79
0.0065" - 0.0074"	0.0095" - 0.0104"	1.91	14.31	13.73	13.16	12.59	12.03
< 0.0065"	< 0.0095"		Inquire	Inquire	Inquire	Inquire	Inquire

Zinc Phosphate Pretreatment included in price; except for Exterior Polyester which will have the thickness & width extra reduced by \$0.55.

### Price Calculation

Base Price (From Above Table): \_\_\_\_\_ (A)  
 Paint Series-specific Topcoat Price Factor (from Section 6.5): \_\_\_\_\_ (B)  
 Paint Series-specific Backcoat Price (if required; from Section 6.5): \_\_\_\_\_ (C)  
 Total Paint Price: (B + C): \_\_\_\_\_ (D)  
 Paint Film Price: (D) \_\_\_\_\_ X Gauge Factor \_\_\_\_\_ = \_\_\_\_\_ (E)  
 Total Paint Price Per 100 lbs: \_\_\_\_\_ (A + E)

**\*\*Please inquire for gauges and widths not shown.**

### NOTE:

- 1) Perspectra Plus Series™, Perspectra Metallics Series™ and 10,000 Series colours cannot be combined.
- 2) Standard washcoats are QC543 and QC4614. For External Polyester only, QC458 is also a standard washcoat. For all non-standard washcoats, add \$0.46/cwt.

Effective: January 1<sup>st</sup>, 2018

# Pre-Coat Products

Dofasco schedule of price extras, Cdn \$/cwt



## 6.3 10000 Series, Perspectra Plus Series™, Perspectra Metallics Series™ WeatherXL™, Exterior Polyester, Fluorocarbon, and SMP Paint Prices (GU-TPW) \$/cwt

### Galvalume™ Substrate

Minimum Gauge	Nominal Gauge	Gauge Factor	Topcoat/Primer/Wash				
			Width				
			24" TO 30"	Over 30" To Under 35.4"	35.4" To 40"	Over 40" To 50"	Over 50" To 60"
> 0.0454"	>0.0514"	0.36	8.54	7.82	7.09	6.50	-
0.0425" - 0.0454"	0.0485" - 0.0514"	0.39	8.80	8.06	7.37	6.83	-
0.0370" - 0.0424"	0.0425" - 0.0484"	0.43	9.12	8.43	7.76	7.25	-
0.0325" - 0.0369"	0.0375" - 0.0424"	0.49	9.35	8.68	8.06	7.54	6.74
0.0305" - 0.0324"	0.0345" - 0.0374"	0.54	9.61	8.97	8.36	7.88	7.13
0.0275" - 0.0304"	0.0315" - 0.0344"	0.60	9.81	9.19	8.59	8.11	7.40
0.0245" - 0.0274"	0.0285" - 0.0314"	0.65	10.01	9.39	8.79	8.32	7.66
0.0215" - 0.0244"	0.0255" - 0.0284"	0.73	10.23	9.62	9.02	8.57	7.93
0.0195" - 0.0214"	0.0225" - 0.0254"	0.83	10.88	10.30	9.82	9.34	8.88
0.0175" - 0.0194"	0.0205" - 0.0224"	0.92	11.12	10.61	10.14	9.67	9.26
0.0165" - 0.0174"	0.0195" - 0.0204"	0.99	11.28	10.77	10.29	9.81	9.41
0.0155" - 0.0164"	0.0185" - 0.0194"	1.05	11.53	11.03	10.51	10.03	9.53
0.0145" - 0.0154"	0.0175" - 0.0184"	1.10	11.67	11.16	10.65	10.16	9.65
0.0135" - 0.0144"	0.0165" - 0.0174"	1.19	11.81	11.30	10.79	10.30	9.79
0.0125" - 0.0134"	0.0155" - 0.0164"	1.27	11.96	11.45	10.93	10.43	9.94
0.0115" - 0.0124"	0.0145" - 0.0154"	1.36	12.22	11.59	11.07	10.56	10.08
0.0105" - 0.0114"	0.0135" - 0.0144"	1.46	12.40	11.88	11.34	10.83	10.32
0.0095" - 0.0104"	0.0125" - 0.0134"	1.57	12.65	12.12	11.56	11.05	10.53
0.0085" - 0.0094"	0.0115" - 0.0124"	1.71	12.90	12.36	11.79	11.27	10.74
0.0075" - 0.0084"	0.0105" - 0.0114"	1.87	13.16	12.61	12.03	11.49	10.95
0.0065" - 0.0074"	0.0095" - 0.0104"	2.06	13.42	12.86	12.27	11.72	11.17
< 0.0065"	< 0.0095"		Inquire	Inquire	Inquire	Inquire	Inquire

### Price Calculation

Base Price (From Above Table):

Paint Series-specific Topcoat Price Factor (from Section 6.5):

Paint Series-specific Backcoat Price (if required; from Section 6.5):

Total Paint Price: (B + C):

Paint Film Price: (D) \_\_\_\_\_ X Gauge Factor \_\_\_\_\_ =

Total Paint Price Per 100 lbs:

**\*\*Please inquire for gauges and widths not shown.**

#### NOTE:

1) Perspectra Plus Series™, Perspectra Metallics Series™ and 10,000 Series colours cannot be combined.

2) Standard washcoats are QC543 and QC4614. For External Polyester only, QC458 is also a standard washcoat.

For all non-standard washcoats, add \$0.46/cwt.

\_\_\_\_\_ (A)  
 \_\_\_\_\_ (B)  
 \_\_\_\_\_ (C)  
 \_\_\_\_\_ (D)  
 \_\_\_\_\_ (E)  
 \_\_\_\_\_ (A + E)

Effective: January 1<sup>st</sup>, 2018

## Pre-Coat Products

Dofasco schedule of price extras, Cdn \$/cwt



### 6.4 10000 Series, Perspectra Plus Series™, Perspectra Metallics Series™ WeatherXL™, Exterior Polyester, Fluorocarbon, and SMP Paint Prices (GU-TPPW) \$/cwt

#### Galvalume™ Substrate

Topcoat/Primer/Primer/Wash Or Topcoat/Primer/Primer/Backcoat							
Minimum Gauge	Nominal Gauge	Gauge Factor	Width				
			24" TO 30"	Over 30" To Under 35.4"	35.4" To 40"	Over 40" To 50"	Over 50" To 60"
> 0.0454"	>0.0514"	0.36	9.41	8.66	7.88	7.25	-
0.0425" - 0.0454"	0.0485" - 0.0514"	0.39	9.69	8.92	8.19	7.61	-
0.0370" - 0.0424"	0.0425" - 0.0484"	0.43	10.02	9.29	8.59	8.04	-
0.0325" - 0.0369"	0.0375" - 0.0424"	0.49	10.27	9.56	8.88	8.35	7.51
0.0305" - 0.0324"	0.0345" - 0.0374"	0.54	10.54	9.86	9.22	8.68	7.91
0.0275" - 0.0304"	0.0315" - 0.0344"	0.60	10.75	10.08	9.45	8.94	8.20
0.0245" - 0.0274"	0.0285" - 0.0314"	0.65	10.95	10.29	9.67	9.16	8.44
0.0215" - 0.0244"	0.0255" - 0.0284"	0.73	11.19	10.54	9.91	9.41	8.75
0.0195" - 0.0214"	0.0225" - 0.0254"	0.83	11.85	11.29	10.74	10.19	9.71
0.0175" - 0.0194"	0.0205" - 0.0224"	0.92	12.12	11.58	11.06	10.51	10.10
0.0165" - 0.0174"	0.0195" - 0.0204"	0.99	12.31	11.76	11.22	10.70	10.26
0.0155" - 0.0164"	0.0185" - 0.0194"	1.05	12.57	12.02	11.47	10.93	10.39
0.0145" - 0.0154"	0.0175" - 0.0184"	1.10	12.72	12.17	11.61	11.06	10.53
0.0135" - 0.0144"	0.0165" - 0.0174"	1.19	12.87	12.33	11.77	11.22	10.68
0.0125" - 0.0134"	0.0155" - 0.0164"	1.27	13.03	12.48	11.92	11.38	10.82
0.0115" - 0.0124"	0.0145" - 0.0154"	1.36	13.32	12.64	12.08	11.52	10.97
0.0105" - 0.0114"	0.0135" - 0.0144"	1.46	13.52	12.95	12.37	11.81	11.26
0.0095" - 0.0104"	0.0125" - 0.0134"	1.57	13.79	13.21	12.62	12.04	11.49
0.0085" - 0.0094"	0.0115" - 0.0124"	1.71	14.07	13.47	12.87	12.29	11.72
0.0075" - 0.0084"	0.0105" - 0.0114"	1.87	14.34	13.74	13.13	12.54	11.95
0.0065" - 0.0074"	0.0095" - 0.0104"	2.06	14.64	14.02	13.39	12.79	12.19
< 0.0065"	< 0.0095"		Inquire	Inquire	Inquire	Inquire	Inquire

#### Price Calculation

Base Price (From Above Table):

Paint Series-specific Topcoat Price Factor (from Section 6.5):

Paint Series-specific Backcoat Price (if required; from Section 6.5):

Total Paint Price: (B + C):

Paint Film Price: (D) \_\_\_\_\_ X Gauge Factor \_\_\_\_\_ =

Total Paint Price Per 100 lbs:

**\*\*Please inquire for gauges and widths not shown.**

#### NOTE:

1) Perspectra Plus Series™, Perspectra Metallics Series™ and 10,000 Series colours cannot be combined.

2) Standard washcoats are QC543 and QC4614. For External Polyester only, QC458 is also a standard washcoat.

For all non-standard washcoats, add \$0.46/cwt.

\_\_\_\_\_ (A)  
 \_\_\_\_\_ (B)  
 \_\_\_\_\_ (C)  
 \_\_\_\_\_ (D)  
 \_\_\_\_\_ (E)  
 \_\_\_\_\_ (A + E)

Effective: January 1<sup>st</sup>, 2018

## Pre-Coat Products

Dofasco schedule of price extras, Cdn \$/cwt



### 6.5 10000 Series, Perspectra Plus Series™, Perspectra Metallics Series™ WeatherXL™, Exterior Polyester, Fluorocarbon, and SMP Paint Prices \$/cwt

#### 6.5.1 10000 Series \$/cwt

QC Numbers	Description	Group	\$/cwt
<b>Whites (13W)</b>			
195	ARCTIC WHITE	Whites	16.12
1051	DARLINGTON WHITE	Whites	16.12
7394	OFF WHITE	Whites	16.12
7441	ANTIQUE LINEN	Whites	16.12
7605	HIGGINS WHITE	Whites	16.12
<b>Earthtones (13E)</b>			
193	BLACK	Earthtones	16.60
196	METRO BROWN	Earthtones	16.60
690	CHARCOAL	Earthtones	16.60
998	STONE GREY	Earthtones	16.60
3654	SAND BEIGE	Earthtones	16.60
3659	GREYBERRY	Earthtones	16.60
3661	PEBBLE	Earthtones	16.60
3855	TERRACOTTA	Earthtones	16.60
6532	BROWN	Earthtones	16.60
7038	SABLE	Earthtones	16.60
7135	DARK BRONZE	Earthtones	16.60
7601	TAN	Earthtones	16.60
7602	REGENT GREY	Earthtones	16.60
7627	BEIGE	Earthtones	16.60
7635	BROWN	Earthtones	16.60
7686	PEARL GREY	Earthtones	16.60
7688	GREY	Earthtones	16.60
7765	SLATE GREY	Earthtones	16.60
<b>Colours (13C)</b>			
184	SLATE BLUE	Colours	19.34
201	FAIR GREEN	Colours	19.34
3643	CORDOVAN	Colours	19.34
7461	AGED COPPER	Colours	19.34
7651	COTTAGE RED	Colours	19.34
7701	AIRPORT BLUE	Colours	19.34
<b>Exotics (13X) - Price by Colour</b>			
3640	WILLOW GREEN	Exotics	30.50
3644	TWILIGHT BLUE	Exotics	30.50
3651	WINTERGREEN	Exotics	30.50
7134	HART GREEN	Exotics	30.50
7603	DARK GREEN	Exotics	30.50

**NOTE:**

- 1) To calculate total painted steel prices, use the price matrices shown in section 6.1 – 6.4.
- 2) QC's will be discontinued if not used within a 12 month period. If colour needs to be reinstated, please contact your ArcelorMittal Dofasco representative.
- 3) Perspectra Plus Series™, Perspectra Metallics Series™ and 10,000 Series colours cannot be combined.

Effective: January 1<sup>st</sup>, 2018

## Pre-Coat Products

Dofasco schedule of price extras, Cdn \$/cwt



### 6.5.2 Perspectra Plus Series™

\$/cwt

QC Numbers	Description	Group	\$/cwt
<b>Standard Whites (80W)</b>			
28076	PUTNAM IVORY	Whites	5.74
28273	BONE WHITE	Whites	5.74
28317	WHITE WHITE	Whites	5.74
28464	USDA WHITE	Whites	5.74
28695	CAMBRIDGE WHITE	Whites	5.74
28696	ANTIQUE LINEN	Whites	5.74
28783	BRITE WHITE	Whites	5.74
28008	POLAR WHITE	Whites	5.74
28180	WHITE	Whites	5.74
28154	IMPERIAL WHITE	Whites	5.74
28149	BONE	Whites	5.74
<b>Standard Earthtones (80E)</b>			
28021	BEIGE	Earthtones	6.25
28055	BUCKSKIN	Earthtones	6.25
28228	METRO BROWN	Earthtones	6.25
28229	DARK BROWN	Earthtones	6.25
28259	TILE RED	Earthtones	6.25
28262	BLACK	Earthtones	6.25
28276	GOLD	Earthtones	6.25
28305	STONE GREY	Earthtones	6.25
28306	CHARCOAL	Earthtones	6.25
28315	TAN	Earthtones	6.25
28326	COFFEE	Earthtones	6.25
28719	MAHOGANY BROWN	Earthtones	6.25
28730	REGENT GREY	Earthtones	6.25
28129	PEBBLE KHAKI	Earthtones	6.25
28186	ASH GREY	Earthtones	6.25
28086	LIGHT STONE	Earthtones	6.25
28054	ZINC GREY	Earthtones	6.25
<b>Standard Colours (80C)</b>			
28250	DARK RED	Colours	8.57
28256	MIST GREEN	Colours	8.57
28258	PACIFIC TURQUOISE	Colours	8.57
28260	SLATE BLUE	Colours	8.57
28261	SAPPHIRE BLUE	Colours	8.57
28307	MELCHERS GREEN	Colours	8.57
28329	GREEN	Colours	8.57
28330	HERON BLUE	Colours	8.57
28790	BRITE BLUE	Colours	8.57
28011	BURGUNDY	Colours	8.57
<b>Standard Exotics (80X)</b>			
28234	INTERNATIONAL ORANGE	Exotics	14.52
28386	BRIGHT RED	Exotics	14.52

**NOTE:**

- 1) To calculate total painted steel prices, use the price matrices shown in 6.1 – 6.4.
- 2) Standard washcoats are QC 543 and QC 4614. For all non standard washcoats, add \$0.46/cwt.
- 3) QC's will be discontinued if not used within a 12 month period. If colour needs to be reinstated, please contact your ArcelorMittal Dofasco representative.

Effective: January 1<sup>st</sup>, 2018

## Pre-Coat Products

Dofasco schedule of price extras, Cdn \$/cwt



### 6.5.3 Perspectra Metallics Series™

\$/cwt

QC Numbers	Description	\$/cwt
10319	PEWTER	25.00
10320	BRIGHT SILVER	25.00
10321	COPPER METALLIC	25.00
10322	GRAPHITE	25.00
10400	SILVER	25.00

**NOTE:**

1) To calculate total painted steel prices, use the price matrices shown in 6.1 – 6.4.

2) Standard washcoats are QC 543 and QC 4614. For all non standard washcoats, please contact your ArcelorMittal Dofasco representative.

### 6.5.4 Exterior Polyester

\$/cwt

QC Number	Description	\$/cwt	QC Number	Description	\$/cwt
417	WHITE	7.76	6522	NEW WHITE	4.73
1849	WHITE	9.25	6569	ALMOND	5.77
1865	CREAM	5.05	6743	PLATINUM	6.62
2150	PORTES TAN	8.41	6827	WHITE	5.54
2437	BONE WHITE	7.43	6938	WHITE	4.67
2628	BLACK COFFEE	8.29	6981	ARCTIC WHITE	4.71
2755	BLACK	4.40	6990	LIGHT GREY	4.74
2761	BROWN	8.01	7009	PRIME WHITE	3.23
2858	BRONZE	6.39	7024	WHITE	6.74
2943	WHITE	4.63	7183	WHITE	8.74
3375	WHITE	7.43	7192	OFF WHITE	6.97
3953	NEW WHITE	5.37	7207	ICE WHITE	4.55
4023	HUNTER GREEN	9.04	7254	BRITE WHITE	6.78
4597	WHITE	4.72	7353	SABLE	5.19
4654	WHITE	3.97	7414	COM BROWN	5.91
4659	BROWN	8.50	7507	BROWN	5.71
4769	SILVER SAGE	4.38	7607	POLAR WHITE	4.94
5199	BROWN	6.49	7690	WHITE	5.57
5576	BROWN	5.87	7737	EU GRAY	4.57
5679	BROWN	8.58	7756	NEW TAUPE	5.08
5932	ICE WHITE	4.98	7837	NEW BRIGHT WHITE	15.80
5977	TAUPE	6.14	8142	OYSTER	5.18
6411	SANDSTONE	7.02	9281	UTILITY GREY	4.12
6490	WHITE	5.09	60031	COOL LG BLACK	19.81
6501	BEIGE	6.54	60125	COOL GRAY	9.66
			60118	COOL BROWN	10.46
			60116	COOL MIDNIGHT BLACK	15.17

**NOTE:**

1) To calculate total painted steel prices, use the price matrices shown in 6.1 – 6.4.

2) Standard washcoats are QC 543, QC 458 and QC 4614. For all non standard washcoats, add \$0.46/cwt.

3) QC's will be discontinued if not used within a 12 month period. If colour needs to be reinstated, please contact your ArcelorMittal Dofasco representative.

Effective: January 1<sup>st</sup>, 2018

# Pre-Coat Products

Dofasco schedule of price extras, Cdn \$/cwt



## 7.0 Barrier Series and Solano® Paint System Prices

\$/cwt

## 7.1 Galvanized Barrier Series And Solano®

\$/cwt

Topcoat/Primer/Primer/Wash Or Topcoat/Primer/Primer/Backcoat

Minimum Gauge	Nominal Gauge	Gauge Factor	Width				
			24" TO 30"	Over 30" To Under 35.4"	35.4" To 40"	Over 40" To 50"	Over 50" To 60"
> 0.0454"	>0.0514"	0.33	\$18.44	\$17.71	\$16.99	\$16.24	-
0.0425" - 0.0454"	0.0485" - 0.0514"	0.38	18.55	17.82	17.09	16.34	-
0.0370" - 0.0424"	0.0425" - 0.0484"	0.42	18.67	17.93	17.22	16.47	-
0.0325" - 0.0369"	0.0375" - 0.0424"	0.48	18.80	18.06	17.34	16.60	15.87
0.0305" - 0.0324"	0.0345" - 0.0374"	0.53	18.93	18.19	17.46	16.73	16.00
0.0275" - 0.0304"	0.0315" - 0.0344"	0.58	19.05	18.29	17.59	16.84	16.13
0.0245" - 0.0274"	0.0285" - 0.0314"	0.63	19.16	18.45	17.71	16.99	16.24
0.0215" - 0.0244"	0.0255" - 0.0284"	0.71	19.29	18.58	17.83	17.11	16.38
0.0195" - 0.0214"	0.0225" - 0.0254"	0.80	19.42	18.70	17.96	17.23	16.49
0.0175" - 0.0194"	0.0205" - 0.0224"	0.89	19.55	18.84	18.09	17.36	16.61
0.0165" - 0.0174"	0.0195" - 0.0204"	0.95	19.69	18.95	18.22	17.49	16.75
0.0155" - 0.0164"	0.0185" - 0.0194"	1.00	19.82	19.08	18.34	17.62	16.87
0.0145" - 0.0154"	0.0175" - 0.0184"	1.05	19.95	19.20	18.47	17.75	17.00
0.0135" - 0.0144"	0.0165" - 0.0174"	1.13	20.08	19.32	18.59	17.84	17.13
0.0125" - 0.0134"	0.0155" - 0.0164"	1.20	20.21	19.46	18.73	17.97	17.25
0.0115" - 0.0124"	0.0145" - 0.0154"	1.28	20.34	19.56	18.85	18.10	17.38

Zinc Phosphate Pretreatment included in price.

### Price Calculation

Base Price (From Above Table):

Paint Series-specific Topcoat Price Factor (from Section 7.2 - 7.3):

Paint Series-specific Backcoat Price (if required; from Section 7.2 - 7.3):

Total Paint Price: (B + C):

Paint Film Price: (D) \_\_\_\_\_ X Gauge Factor \_\_\_\_\_ =

Total Paint Price Per 100 lbs:

\_\_\_\_\_ (A)

\_\_\_\_\_ (B)

\_\_\_\_\_ (C)

\_\_\_\_\_ (D)

\_\_\_\_\_ (E)

\_\_\_\_\_ (A + E)

**\*\*Please inquire for gauges and widths not shown.**

#### NOTE:

1) Maximum Barrier Series and Solano® coil weights is 10,000 lbs.

2) All Barrier Series and Solano® topcoats are embossed.

3) Nominal gauge must be 0.021" or greater for coating thickness equal to or greater than 8 mil.

4) Barrier Series and Solano® cannot be combined with Perspectra Plus or 10,000 series.

5) Barrier Series and Solano® runs on #3-line only. Validate coil processing capabilities with your ArcelorMittal Dofasco representative before ordering.

Effective: January 1<sup>st</sup>, 2018

## Pre-Coat Products

Dofasco schedule of price extras, Cdn \$/cwt



### 7.2 Barrier Series Topcoat Colours And Paint Prices

\$/cwt

QC Numbers	Description	4 Mil	8 Mil	12 Mil
1501	WHITE	14.61	29.23	43.83
1504	CHARCOAL	18.39	36.78	55.17
1508	BONE WHITE	14.17	28.35	42.52
1509	PAC.TURQU.	16.64	33.29	49.94
1513	LIGHT GREY	17.16	34.31	51.46
1517	BLACK	14.90	29.80	44.71
1518	DARK BROWN	18.32	36.63	54.96
1520	SEA GREEN	17.30	34.60	51.90
1524	CAN'RS BROWN	19.19	38.38	57.58
1539	ANTIQUAIVORY	17.45	34.89	52.34
1546	INTERIOR WHT	12.51	25.00	37.51
1555	SKY BLUE	22.75	45.51	68.26
1556	SAPPHIREBLUE	21.66	43.33	64.98
1558	TILE RED	17.16	34.31	51.46
1562	DOVE GREY	15.63	31.26	46.89
1565	MOCASSIN	15.34	30.68	46.01
1573	ALOUETTETEAL	37.29	74.58	111.87
1575	ALOUWHITE	13.16	26.32	39.47
1576	ALOUBBLUE	27.77	55.53	83.31
1581	BEIGE	14.98	29.95	44.92
1583	WICKERTONE	15.63	31.26	46.89
1584	WILLSGREY	14.75	29.52	44.27
1588	DEEP GREY	12.57	25.15	37.73
1594	RESIDENTIAL GREEN	23.05	46.08	69.13
7164	SLATE BLUE	22.53	45.07	67.60
7372	GULF GREEN	17.16	34.31	51.46
7712	SLATE BLUE	21.66	43.33	64.98
7899	TAN	15.78	31.55	47.32
8999	ROCKPORT GRAY	16.07	32.13	48.19
9060	SURF GREEN	17.30	34.60	51.90

**NOTE:**

- 1) To calculate total painted steel prices, use the price matrices shown in 7.1.
- 2) QC 1546 (Int.White) is for liner sheet only. Do not use as exterior panel.
- 3) Topcoat limits: 4 mil. minimum/12 mil. maximum. Backcoat limits: 4 mil. minimum/8 mil. maximum.
- 4) Please contact your ArcelorMittal Dofasco representative for gauge restrictions.
- 5) QC's will be discontinued if not used within a 12 month period. If colour needs to be reinstated, please contact your ArcelorMittal Dofasco representative.

Effective: January 1<sup>st</sup>, 2018

## Pre-Coat Products

Dofasco schedule of price extras, Cdn \$/cwt



### 7.3 Solano®

			\$ /cwt	
Q.C.	Paint Colour		\$/cwt 4 Mil	\$/cwt 8 Mil
60013	CHARCOAL		18.09	36.18
60015	BLACK		16.66	33.32
60016	DARK BROWN		17.20	34.41
60017	CANNERS BROWN		19.24	38.49
60018	TILE RED		16.52	33.05
60020	HUNTER GREEN		26.93	53.86
60019	DEEP GREY		Inquire	Inquire
60090	USDA WHITE		Inquire	Inquire
60097	INTERWHITE		Inquire	Inquire
60104	BONE WHITE		Inquire	Inquire
60105	COOL BLACK		Inquire	Inquire

**NOTE:**

- 1) To calculate total painted steel prices, use the price matrices shown in 7.1
- 2) Topcoat limits: 4 mil. Minimum/8 mil. Maximum. Please validate Backcoat limits with your ArcelorMittal Dofasco representative before ordering
- 3) Please contact your ArcelorMittal Dofasco representative for gauge restrictions.
- 4) QC's will be discontinued if not used within a 12 month period. If colour needs to be reinstated, please contact your ArcelorMittal Dofasco representative.

Effective: January 1<sup>st</sup>, 2018

## Pre-Coat Products

Dofasco schedule of price extras, Cdn \$/cwt



### 8.0 Metallic And Elite Series and TagTough® Paint System Prices

\$/cwt

### 8.1 Galvanized - Metallic And Elite Series™ and TagTough®

\$/cwt

Primer/Basecoat/Topcoat/Clear/Primer/Wash

Minimum Gauge	Nominal Gauge	Gauge Factor	Width				
			24" TO 30"	Over 30" To Under 35.4"	35.4" To 40"	Over 40" To 50"	Over 50" To 60"
> 0.0454"	>0.0514"	0.33	32.11	31.18	30.24	29.32	-
0.0425" - 0.0454"	0.0485" - 0.0514"	0.38	32.21	31.28	30.33	29.40	-
0.0370" - 0.0424"	0.0425" - 0.0484"	0.42	32.30	31.37	30.43	29.49	-
0.0325" - 0.0369"	0.0375" - 0.0424"	0.48	32.39	31.46	30.52	29.58	28.64
0.0305" - 0.0324"	0.0345" - 0.0374"	0.53	32.48	31.55	30.60	29.66	28.72
0.0275" - 0.0304"	0.0315" - 0.0344"	0.58	32.57	31.63	30.69	29.76	28.82
0.0245" - 0.0274"	0.0285" - 0.0314"	0.63	32.66	31.72	30.78	29.84	28.90
0.0215" - 0.0244"	0.0255" - 0.0284"	0.71	32.75	31.81	30.86	29.92	28.98
0.0195" - 0.0214"	0.0225" - 0.0254"	0.80	32.82	31.88	30.95	30.01	29.07
0.0175" - 0.0194"	0.0205" - 0.0224"	0.89	32.91	31.98	31.04	30.10	29.17
0.0165" - 0.0174"	0.0195" - 0.0204"	0.95	33.00	32.06	31.12	30.18	29.24
0.0155" - 0.0164"	0.0185" - 0.0194"	1.00	33.07	32.15	31.22	30.28	29.34
0.0145" - 0.0154"	0.0175" - 0.0184"	1.05	33.16	32.23	31.31	30.37	29.43
0.0135" - 0.0144"	0.0165" - 0.0174"	1.13	33.25	32.32	31.39	30.45	29.52
0.0125" - 0.0134"	0.0155" - 0.0164"	1.20	33.34	32.41	31.48	30.54	29.60
0.0115" - 0.0124"	0.0145" - 0.0154"	1.28	33.42	32.51	31.57	30.63	29.69
0.0105" - 0.0114"	0.0135" - 0.0144"	1.37	33.51	32.59	31.66	30.72	29.78

Zinc Phosphate Pretreatment included in price.

#### Price Calculation

Base Price (From Above Table):

Paint Series-specific Topcoat Price Factor (from Section 8.3):

Paint Film Price: (B) \_\_\_\_\_ X Gauge Factor \_\_\_\_\_ = \_\_\_\_\_

Total Paint Price Per 100 lbs:

\_\_\_\_\_ (A)

\_\_\_\_\_ (B)

\_\_\_\_\_ (C)

\_\_\_\_\_ (A + C)

Effective: January 1<sup>st</sup>, 2018

## Pre-Coat Products

Dofasco schedule of price extras, Cdn \$/cwt



### 8.2 Galvalume™ – Metallic and Elite Series and TagTough®

\$/cwt

Primer/Basecoat/Topcoat/Clear/Primer/Wash

Minimum Gauge	Nominal Gauge	Gauge Factor	Width				
			24" TO 30"	Over 30" To Under 35.4"	35.4" To 40"	Over 40" To 50"	Over 50" To 60"
> 0.0454"	>0.0514"	0.36	31.04	30.09	29.18	28.26	-
0.0425" - 0.0454"	0.0485" - 0.0514"	0.38	31.97	31.00	30.05	29.10	-
0.0370" - 0.0424"	0.0425" - 0.0484"	0.42	32.07	31.10	30.15	29.19	-
0.0325" - 0.0369"	0.0375" - 0.0424"	0.48	32.16	31.20	30.25	29.28	28.32
0.0305" - 0.0324"	0.0345" - 0.0374"	0.53	32.26	31.29	30.30	29.37	28.42
0.0275" - 0.0304"	0.0315" - 0.0344"	0.58	32.35	31.37	30.41	29.48	28.53
0.0245" - 0.0274"	0.0285" - 0.0314"	0.63	32.43	31.47	30.51	29.56	28.61
0.0215" - 0.0244"	0.0255" - 0.0284"	0.71	32.52	31.55	30.61	29.64	28.67
0.0195" - 0.0214"	0.0225" - 0.0254"	0.80	32.60	31.63	30.68	29.73	28.77
0.0175" - 0.0194"	0.0205" - 0.0224"	0.89	32.69	31.73	30.77	29.83	28.88
0.0165" - 0.0174"	0.0195" - 0.0204"	0.95	32.77	31.82	30.87	29.89	28.96
0.0155" - 0.0164"	0.0185" - 0.0194"	1.00	32.85	31.89	30.96	30.00	29.06
0.0145" - 0.0154"	0.0175" - 0.0184"	1.05	32.94	31.98	31.06	30.11	29.15
0.0135" - 0.0144"	0.0165" - 0.0174"	1.13	33.06	32.08	31.15	30.17	29.23
0.0125" - 0.0134"	0.0155" - 0.0164"	1.20	33.16	32.17	31.22	30.26	29.33
0.0115" - 0.0124"	0.0145" - 0.0154"	1.28	33.23	32.28	31.32	30.37	29.42
0.0105" - 0.0114"	0.0135" - 0.0144"	1.37	33.33	32.37	31.43	30.47	29.49

#### Price Calculation

Base Price (From Above Table):

Paint Series-specific Topcoat Price Factor (from Section 8.3):

Paint Film Price: (B) \_\_\_\_\_ X Gauge Factor \_\_\_\_\_ = \_\_\_\_\_

Total Paint Price Per 100 lbs:

\_\_\_\_\_ (A)

\_\_\_\_\_ (B)

\_\_\_\_\_ (C)

\_\_\_\_\_ (A + C)

Effective: January 1<sup>st</sup>, 2018

## Pre-Coat Products

Dofasco schedule of price extras, Cdn \$/cwt



### 8.3.1 Metallic And Elite Series Topcoat Colours And Paint Prices

\$/cwt

QC Numbers	Description	\$/cwt
198	HERON BLUE	127.08
2624	BRIGHTSILVER	85.24
2897	LIGHT PEWTER	86.16
2899	MED BRONZE	107.82
3234	COPPER MET	84.26
3263	CHAMPAGNE	99.52
3365	WHITE (base white)	0.00
3645	AGED COPPER	98.31
4096	CLEAR (clear coat)	78.76
5365	PEWTER	84.60
5455	BANNER RED	112.61
5904	RAGGREEN	99.48
6061	HOT RED	115.65
6508	SLATE GREY	82.14
6637	ORANGE	97.38
6695	DARK BRONZE	88.52
6702	CHAMPAGNE	98.81
6723	GOLDGATE YELLOW	98.08
6724	SILVER	84.07
6754	QUAKER GREY	83.55
6824	REDWOOD	99.48
6855	SILVER GRAY	83.55
6856	SEAFOAM GREEN	98.08
6911	BRONZE MET	85.80
6914	RONA ORANGE	97.38
7053	COPPERTAUPE	90.04
7236	ROYALE BLUE	97.38
7417	SILVER METAL	84.06

**NOTE:**

1) To calculate the total painted steel prices, use the price matrices shown in 8.1 and 8.2.

2) QC's will be discontinued if not used within a 12 month period. If a colour needs to be reinstated, contact your ArcelorMittal Dofasco representative.

Effective: January 1<sup>st</sup>, 2018

## Pre-Coat Products

Dofasco schedule of price extras, Cdn \$/cwt



### 8.3.2 TagTough® Paint Prices (Graffiti Resistant Coating)

\$/cwt

60143	CAMBRIDGE WHITE	Inquire
60145	BLACK	Inquire
60147	RED	Inquire
60148	CHARCOAL	Inquire
60150	BRIGHT SILVER	Inquire

**NOTE:**

- 1) To calculate the total painted steel price for TagTough®, contact your ArcelorMittal Dofasco sales representative to obtain the topcoat price factor and use the price matrices shown in 8.1 and 8.2.
- 2) QC's will be discontinued if not used within a 12 month period. If colour needs to be reinstated, contact your ArcelorMittal Dofasco representative.



™ - ArcelorMittal (logo/slogan) is a trademark of ArcelorMittal  
Our product is steel. Our strength is people.®

Galvalume™ is a trademark of ArcelorMittal in Canada and a trademark of BIEC International Inc. in the United States.  
ArcelorMittal is a licensed Galvalume producer through the Zinc Aluminum Coaters (ZAC) Association, which ensures  
that proper production technology and the highest product quality standards are met.



ArcelorMittal Dofasco G.P.  
Box 2460, 1330 Burlington Street East  
Hamilton, ON L8N 3J5 Canada  
[dofasco.arcelormittal.com](http://dofasco.arcelormittal.com)

Twitter: @ArcelorMittal\_D  
Facebook: [facebook.com/arcelormittaldofasco](https://facebook.com/arcelormittaldofasco)

T 1-800-816-6333  
E [customer-inquiries.dofasco@arcelormittal.com](mailto:customer-inquiries.dofasco@arcelormittal.com)

worldsteel  
ASSOCIATION

